



Portland Place

Abington, Northampton



GROUND FLOOR
505 sq.ft. (46.9 sq.m.) approx.

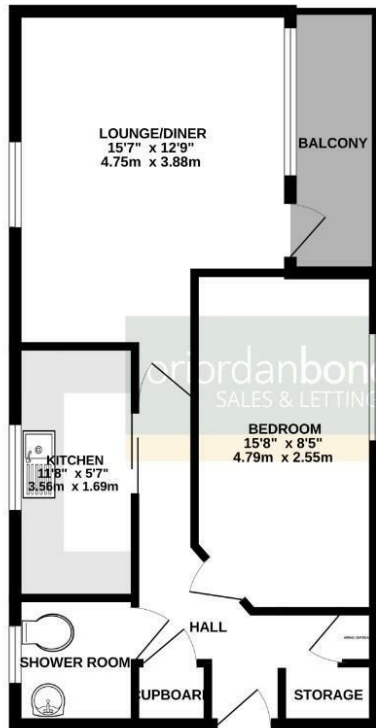

TOTAL FLOOR AREA : 505 sq.ft. (46.9 sq.m.) approx.
Whilst every attempt has been made to ensure the accuracy of the floorplan contained herein, measurements of doors, windows, rooms and any other items are approximate and no responsibility is taken for any error, omission or misstatement. This plan is for illustrative purposes only and should be used as such by any prospective purchaser. The services, systems and appliances shown have not been tested and no guarantee as to their operability or efficiency can be given.
Made with Hozomeq C2025

Portland Place

Abington

NN1 4DH

PRICE £110,000

A spacious one double bedroom first floor apartment situated within walking distance to the town centre and local amenities. There is also good access to the general hospital.

The accommodation comprises secure communal entry, entrance hall, sitting/dining room with door to balcony, kitchen with built-in cooking appliances, storage cupboard/utility, further storage cupboard, large double bedroom and a shower room. Outside is communal parking. Further benefits include uPVC double glazing and gas radiator heating serviced via a combination boiler. (C/505/-)

Leasehold Information: Lease Remaining - 102 years (as of 2026) / Ground Rent & Service Charges - £68.96 pcm

Additional information

- Council Tax Band: A
- Energy Efficiency Rating: D

Viewing

Viewing strictly by appointment – details below

Disclaimer

O'Riordan Bond Estate Agents Limited has not tested apparatus, equipment, fittings or services and so cannot verify they are in working order. The buyer is advised to obtain verification from their solicitor or surveyor.

O'Riordan Bond Abington Sales
01604 639007

abington@oriordanbond.co.uk

